

34 Series Indoor Number & Letters (B-507)

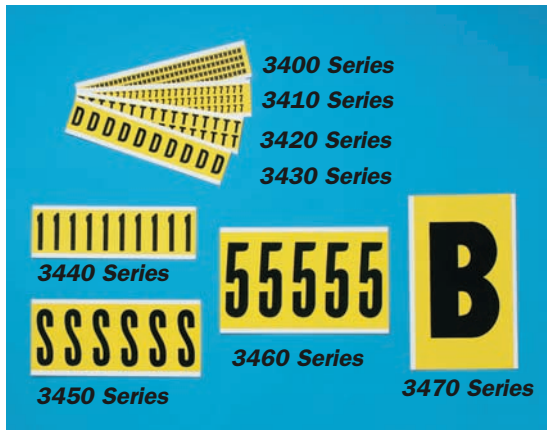

Brady's 34 Series Numbers and Letters are perfect for fast, general purpose indoor marking.

- B-507 plastic coated cloth numbers & letters with pressure sensitive adhesive
- Black characters on a yellow background
- Permanent or Repositionable: once applied, numbers & letters are there to stay...unless you want to change them
- Special high-tack adhesive sticks to any clean, dry surface
- Order by card only

Character Legibility Table	Letter Size (Inches)	Readability Distance (Feet)
The Legibility Table can help you determine what size your markers should be for good readability at varying distances.	1	up to 40
	1½	up to 60
	2	up to 75
	3	up to 105
	4	up to 150
	6	up to 300
ANSI Z35.1 1972		



Catalog Number	Markers Per Card	Character Height	Marker Size H x W	Card Size H x W
3400-*	144	¼"	⅜" x ¼"	2" x 9"
3410-*	78	⅜"	½" x 11/32"	2" x 9"
3420-*	32	⅝"	¾" x 9/16"	2" x 9"
3430-*	10	1"	1½" x 7/8"	2" x 9"
3440-*	10	1½"	2¼" x 7/8"	2¾" x 9"
3450-*	6	2½"	3½" x 1½"	4" x 9"
3460-*	5	3⅞"	5" x 1¾"	9" x 5½"
3470-*	1	6"	9" x 5"	9" x 5½"

Stock Cards: Numbers 0-9; Capital Letters A-Z; Dash; Arrows available in 3420-*, 3430-*, 3440-*, 3450-* Series; BLNK available in 3400-*, 3410-*, 3430-*, 3440-*, 3450-*, 3460-*, and 3470-* Series.

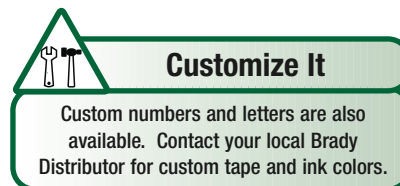

To Order Stock:

1. Select the size marker required for your application (see character legibility table above).
2. Refer to table (above) to find the catalog number for the marker size you require, and the number of markers per card.
3. Substitute the number or letter you need for the asterisk following the catalog number. Use the abbreviation DSH to order dashes, ARO to order arrows, and BLNK to order blanks.
4. To determine the number of cards to order, divide the total number of characters needed of a given item by the number of markers per card.

34 Series Numbers and Letters can be removed - great for frequent stock changes!

34 Series Combination Packs (B-507)

- B-507 plastic coated cloth tape with pressure sensitive adhesive
- Assorted markers on a dispenser card
- Number packs contain all numbers from 0-9; number of cards vary according to their frequency of use
- Black characters on a yellow background
- Standard package: letters - 25 assorted cards; numbers - 25 assorted cards

Catalog Number				
Letter Assortment	Number Assortment	Marker Size H x W	Character Height	Markers Per Card
34051	34052	3/8" x 1/4"	1/4"	144
34151	34152	1/2" x 11/32"	3/8"	78
34251	34252	3/4" x 9/16"	5/8"	32
34351	34352	1 1/2" x 7/8"	1"	10
34451	34452	2 1/4" x 7/8"	1 15/16"	10
34551	34552	3 1/2" x 1 1/2"	2 15/16"	6
34651	34652	5" x 1 3/4"	3 7/8"	5
34751	34752	9" x 5"	6"	1



34 Series Combination Packs provide all the numbers and letters you need for general purpose indoor marking.

Consecutive Markers

- B-507 plastic coated cloth tape
- Black characters on a yellow background
- Contain numerical or alphabetical sequences on same card
- Small marker sizes contain complete numerical or alphabetical sequences
- Larger sized cards break the alphabet into three parts: A-J, K-T, and U-Z

Catalog Number	Card Legend	Character Height	Marker Size H x W	Markers Per Card
34010	(0-9)	1/4"	3/8" x 1/4"	144
34110	(0-9)	3/8"	1/2" x 11/32"	78
34138	(A-Z)	3/8"	1/2" x 11/32"	78
34210	(0-9)	5/8"	3/4" x 9/16"	32
34238	(A-Z)	5/8"	3/4" x 9/16"	32
34310	(0-9)	1"	1 1/2" x 7/8"	10
34340	(A-J)	1"	1 1/2" x 7/8"	10
34341	(K-T)	1"	1 1/2" x 7/8"	10
34342	(U-Z)	1"	1 1/2" x 7/8"	10
34410	(0-9)	1 15/16"	2 1/4" x 7/8"	10
34440	(A-J)	1 15/16"	2 1/4" x 7/8"	10
34441	(K-T)	1 15/16"	2 1/4" x 7/8"	10
34442	(U-Z)	1 15/16"	2 1/4" x 7/8"	10



Use Consecutive Markers for all of your customization needs.

Seriesystem™ Kit Serialized Markers

- B-507 plastic coated cloth tape
- Black characters on a yellow background
- 10 single digit cards (0-9) included in each kit for replacement numbers
- Combine kits with 1" or 5/8" numbers or letters to form longer sequences
- Standard package: complete kit

Catalog Number	Description	Marker Size H x W	Letter Height	Markers Per Card	Cards Per Kit
34253	001-999	3/4" x 1 1/2"	5/8"	12	94
34353	01-99	1 1/2" x 1 1/2"	1"	6	27



Use Brady's Seriesystem™ Kit to sequentially number your shelves, drawers, files or bins.

34 Series Combination Packs (B-507)

- B-507 plastic coated cloth tape with pressure sensitive adhesive
- Assorted markers on a dispenser card
- Number packs contain all numbers from 0-9; number of cards vary according to their frequency of use
- Black characters on a yellow background
- Standard package: letters - 25 assorted cards; numbers - 25 assorted cards

Catalog Number				
Letter Assortment	Number Assortment	Marker Size H x W	Character Height	Markers Per Card
34051	34052	3/8" x 1/4"	1/4"	144
34151	34152	1/2" x 11/32"	3/8"	78
34251	34252	3/4" x 9/16"	5/8"	32
34351	34352	1 1/2" x 7/8"	1"	10
34451	34452	2 1/4" x 7/8"	1 5/16"	10
34551	34552	3 1/2" x 1 1/2"	2 5/16"	6
34651	34652	5" x 1 3/4"	3 7/8"	5
34751	34752	9" x 5"	6"	1



34 Series Combination Packs provide all the numbers and letters you need for general purpose indoor marking.

Consecutive Markers

- B-507 plastic coated cloth tape
- Black characters on a yellow background
- Contain numerical or alphabetical sequences on same card
- Small marker sizes contain complete numerical or alphabetical sequences
- Larger sized cards break the alphabet into three parts: A-J, K-T, and U-Z

Catalog Number	Card Legend	Character Height	Marker Size H x W	Markers Per Card
34010	(0-9)	1/4"	3/8" x 1/4"	144
34110	(0-9)	3/8"	1/2" x 11/32"	78
34138	(A-Z)	3/8"	1/2" x 11/32"	78
34210	(0-9)	5/8"	3/4" x 9/16"	32
34238	(A-Z)	5/8"	3/4" x 9/16"	32
34310	(0-9)	1"	1 1/2" x 7/8"	10
34340	(A-J)	1"	1 1/2" x 7/8"	10
34341	(K-T)	1"	1 1/2" x 7/8"	10
34342	(U-Z)	1"	1 1/2" x 7/8"	10
34410	(0-9)	1 5/16"	2 1/4" x 7/8"	10
34440	(A-J)	1 5/16"	2 1/4" x 7/8"	10
34441	(K-T)	1 5/16"	2 1/4" x 7/8"	10
34442	(U-Z)	1 5/16"	2 1/4" x 7/8"	10



Use Consecutive Markers for all of your customization needs.

Seriesystem™ Kit Serialized Markers

- B-507 plastic coated cloth tape
- Black characters on a yellow background
- 10 single digit cards (0-9) included in each kit for replacement numbers
- Combine kits with 1" or 5/8" numbers or letters to form longer sequences
- Standard package: complete kit

Catalog Number	Description	Marker Size H x W	Letter Height	Markers Per Card	Cards Per Kit
34253	001-999	3/4" x 1 1/2"	5/8"	12	94
34353	01-99	1 1/2" x 1 1/2"	1"	6	27



Use Brady's Seriesystem™ Kit to sequentially number your shelves, drawers, files or bins.

15 Series Indoor/Outdoor Numbers & Letters (B-946)

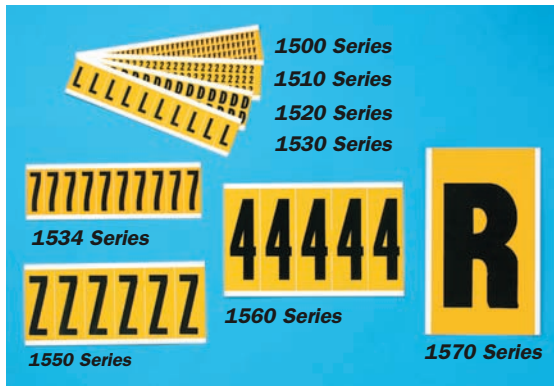

- B-946 premium outdoor grade vinyl with permanent pressure sensitive adhesive
- Available in eight stock sizes
- Superior chemical resistance - resists oil, grease, water and mild solvents
- UV resistance - vinyl printed with fade resistant ink
- Black characters on a yellow background - high visibility
- Designed for permanent applications in severe outdoor environments as well as indoors. Special acrylic adhesive adheres strongly, making marker removal difficult
- Superior abrasion resistance - strongly adhering ink system minimizes the effect of accidental scratches and scrapes; resists scratches without damage to appearance or legibility
- Order by card only



Customize It

Custom numbers and letters are also available. Contact your local Brady Distributor for custom colors and materials.



Use 15 Series Numbers and Letters when long-term durability in a tough environment is required.

Catalog Number	Markers Per Card	Character Height	Marker Size H x W	Card Size H x W
1500.*	144	1/4"	3/8" x 1/4"	2" x 9"
1510.*	78	3/8"	1/2" x 11/32"	2" x 9"
1520.*	32	5/8"	3/4" x 9/16"	2" x 9"
1530.*	10	1"	1 1/2" x 7/8"	2" x 9"
1534.*	10	1 5/16"	2 1/4" x 7/8"	2 3/4" x 9"
1550.*	6	2 15/16"	3 1/2" x 1 1/2"	4" x 9"
1560.*	5	3 7/8"	5" x 1 3/4"	9" x 5 1/2"
1570.*	1	6"	9" x 5"	9" x 5 1/2"

Stock Cards: Numbers 0-9; Capital Letters A-Z; Dash; Arrows available in 1520-*, 1530-*, 1534-*, 1550-* Series.

To Order: Add single digit number or letter in place of asterisk to complete catalog number.

15 Series Combination Packs



- B-946 premium outdoor grade vinyl with permanent pressure sensitive adhesive
- Black characters on a yellow background
- Standard package: letters - 25 assorted cards; numbers - 25 assorted cards

Catalog Number

Letter Assort.	Number Assort.	Marker Size H x W	Character Height	Markers Per Card
94738	94739	3/8" x 1/4"	1/4"	144
94838	94839	1/2" x 11/32"	3/8"	78
97600	97601	3/4" x 9/16"	5/8"	32
97602	97603	1 1/2" x 7/8"	1"	10
97604	97605	2 1/4" x 7/8"	1 5/16"	10
97606	97607	3 1/2" x 1 1/2"	2 15/16"	6
97128	97129	5" x 1 3/4"	3 7/8"	5
97598	97599	9" x 5"	6"	1

Brady's 15 Series Combination Packs make marking in any environment - indoors and out - a snap.

97 Series Indoor/Outdoor Numbers & Letters (B-946)

- B-946 premium outdoor grade vinyl with permanent pressure sensitive adhesive
- Black Helvetica Medium characters on a white background
- Superior chemical resistance - resists oil, grease, water and mild solvents
- UV resistance - vinyl printed with fade resistant ink
- Designed for permanent applications in severe outdoor environments as well as indoors. Special acrylic adhesive adheres strongly, making marker removal difficult
- Superior abrasion resistance - strongly adhering ink system minimizes the effect of accidental scratches and scrapes; resists scratches without damage to appearance or legibility
- Stock cards: numbers 0-9; capital letters A-Z; dash

Catalog Number	Character Height	Marker Size H x W	Card Size H x W	Markers Per Card
9712*	5/8"	3/4" x 2 1/32"	2" x 6 1/2"	20
9713*	1"	1 1/2" x 1 1/16"	2" x 10 5/8"	10
9714*	1 5/16"	2 1/4" x 1 13/16"	3" x 9 1/16"	5



Customize It

Custom numbers and letters are also available. Contact your local Brady Distributor for custom colors and materials.

*To Order Stock:

1. Select the marker size required for your application.
2. Refer to the table (above) to find the catalog number for the marker size you require and the number of markers per card.
3. Substitute the number or letter you need for the asterisk following the catalog number. Use the abbreviation DSH to order dashes.
4. To determine the number of cards to order divide the total number of characters needed of a given item by the number of markers per card.



Helvetica Medium characters give a crisp, professional, timeless appearance.



Use 97 Series markers to permanently identify files and equipment in the office.

97 Series Combination Packs

- B-946 premium grade vinyl with permanent pressure sensitive adhesive
- Black characters on a white background
- Helvetica Medium characters
- Standard package: letters - 25 assorted cards; numbers - 25 assorted cards
- Order by packs only

Catalog Number

Letter Assort.	Number Assort.	Marker Size H x W	Character Height	Markers Per Card
97708	97707	3/4" x 2 1/32"	5/8"	20
97710	97709	1 1/2" x 1 3/16"	1"	10
97712	97711	2 1/4" x 1 13/16"	1 5/16"	5



Use 97 Series Combination Packs with assortments of numbers and letters for any labeling project.

G

Numbers & Letters

Outdoor Numbers & Letters



Identify splice closures and pedestals, transformers and other utility installations with Outdoor Numbers & Letters.

- Made from B-946 tough vinyl film - provides lasting performance in all environments
- High visibility
- Permanent adhesive prevents edge curl and resists tampering
- UV resistant ink protects against fading and shrugs off oil and water
- Meets APWA color-code guidelines: black on orange for telecommunications, yellow on black for electric, oil and gas transmission
- Easy to apply - unique starter strip speeds application
- Standard package: 1 card



Customize It

Custom colors and sizes are also available. Contact your local Brady Distributor for details.

To Order:

Add single digit number or letter in place of asterisk to complete catalog number. Use DSH to order dash.

2222222222

6560 Series

6666666666

6570 Series

2222222222

7890 Series

6666666666

7897 Series

Catalog Number	Marker Size H X W	Letter Height	Markers Per Card
6560-*	1½" x 7/8"	1"	10
6570-*	2¼" x 7/8"	1½/16"	10
7890-*	1½" x 7/8"	1"	10
7897-*	2¼" x 1½"	1½/16"	10

Aluminum Utility Panels



High-visibility Aluminum Utility Panels are easy to use and highly durable for outdoor use.

- Twenty mil. (.020") aluminum panels are designed for ruggedness
- Flexible to conform to pole curve
- Adhere markers to oil-free aluminum panel
- Choose from B-946 outdoor vinyl film or B-997 reflective sheeting with cold temperature adhesive
- Check the table to determine the appropriate panel size and corresponding marker material, located above
- Standard package: 25 panels

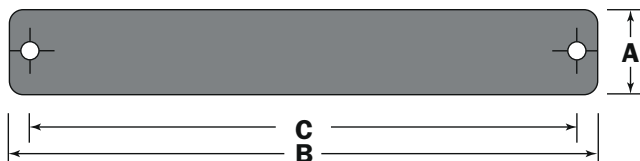

Catalog Number	Overall Size A x B	Marking Area A x C	Recommended Markers	Max. No. of Markers Per Panel
97198	1¾" x 7¼"	1¾" x 6½"	B-946 B-997	8
97199	1¾" x 12"	1¾" x 11¼"	B-946 B-997	12
97201	2½" x 11½"	2½" x 10¾"	B-997	7
97202	3½" x 13½"	3½" x 12¾"	B-997	7

Preprinted KVA Markers



Markers help repair personnel determine the KVA classification of pole-mounted transformers and electrical generating equipment.

- Yellow numbers printed on B-997 BradyLite® Reflective Sheeting
- **For Low Temperature Applications**
Cold temperature adhesive can be applied at temperatures as low as -10°F (-27°C)
- Markers come with slit liner for easy application
- Standard package: 25 identical markers

For legends not shown, apply individual BradyLite® 5000-Series markers (sold separately on page 183) to provide the desired rating.

Catalog Number	Legend	Marker Size
50010	7½	2⅞" x 3¼"
50011	10	2⅞" x 3¼"
50012	15	2⅞" x 3¼"
50013	25	2⅞" x 3¼"
50015	50	2⅞" x 3¼"
50016	75	2⅞" x 3¼"
50014	37½	2⅞" x 4¾"
50017	100	2⅞" x 4¾"
50018	150	2⅞" x 4¾"
50019	167	2⅞" x 4¾"
50020	500	2⅞" x 4¾"



Customize It

Custom KVA Markers are also available. Contact your local Brady Distributor for special legend and color combinations.

Bradylite® Reflective Numbers & Letters

- Made from Engineering Grade B-997 Bradylite® Reflective Material - reflects light 100 times brighter than a plain white surface
- Will perform despite storms, snow, humidity and other tough environmental conditions
- **For Low Temperature Applications**
Cold temperature adhesive can be applied at temperatures as low as -10°F (-27°C)
- High visibility - indoor or outdoor; excellent visibility at night
- Standard package: 25



Customize It

Custom Bradylite® Numbers & Letters can also be made to your specifications for size, color and legend. Contact your local Brady Distributor for special legend and color combinations.



Bradylite® Reflective Numbers & Letters provide high visibility identification at night or during inclement weather.



5000 Series
2 7/8" x 1 3/4"



5890 Series
1 7/8" x 1 3/8"



5900 Series
1 1/2" x 1"



5905 Series
1 1/2" x 1"



5910 Series
1 1/2" x 1"



5920 Series
1 1/2" x 1"

To Order:

Add single digit number or letter in place of asterisk to complete catalog number. Characters available are: A-Z, 0-9. Use DSH to order dash and BLNK to order blank.

Catalog Number	Marker Size H x W	Letter Height	Color
5900.*	1 1/2" x 1"	1"	Black on silver
5905.*	1 1/2" x 1"	1"	Yellow on black
5910.*	1 1/2" x 1"	1"	Black on orange
5920.*	1 1/2" x 1"	1"	Black on yellow
5890.*	1 7/8" x 1 3/8"	1 1/2"	Yellow on black
5000.*	2 7/8" x 1 3/4"	2 1/2"	Yellow on black

Bradylite® Utility Kits

- Made from Engineering Grade B-997 Bradylite® Reflective Material - provides lasting visibility at night and during inclement weather
- **For Low Temperature Applications**
Cold temperature adhesive can be applied at temperatures as low as -10°F (-27°C)
- Kits are preassembled and organized for use in the field
- Numbers and letters are compartmentalized and stored in a clear impact-resistant box. Unique padding feature keeps markers stacked together in case of accidental spills
- Numbers and letters size: 1 1/2" x 1"
- Available with 18 or 36 characters per kit
- Stock 18 kits contain 50 each of: numbers 0-9 and letters A-D, L, P, R and S
- Stock 36 kits contain 25 each of: numbers 0-9, letters A-Z, a dash and a blank

Bradylite® Utility Kits

Catalog Number	Markers Per Compartment	Color
5900-18 Kit	50	Black on silver
5900-36 Kit	25	Black on silver
5905-18 Kit	50	Yellow on black
5905-36 Kit	25	Yellow on black
5910-18 Kit	50	Black on orange
5910-36 Kit	25	Black on orange
5920-18 Kit	50	Black on yellow
5920-36 Kit	25	Black on yellow

Compartment Replacement Case

Catalog Number	Description
59170	18 - Compartment Replacement Case
59171	36 - Compartment Replacement Case



Bradylite® Numbers & Letters are easily transported to and from the job site in Bradylite® Utility Kits.

3 Series Glow-In-The Dark / Ultra Reflective



3 Series Numbers & Letters reflect light and glow bright combining the highest level of reflectivity with advanced glow-in-the-dark technology.

Identifiable in daytime, low light and blackout conditions, the 3 Series is the ultimate in identification marking.



3 Series Glow-In-The-Dark/Ultra Reflective Numbers & Letters

- The 3 Series combines glow-in-the-dark technology with ultra reflective B309 material - 7x More Reflective Than Other Reflective Material
- Black characters with glow-in-the-dark boarder on a highly reflective silver background
- Unique micro-prism reflectors allow for maximum visibility from a greater distance, wider angle and lower light source than standard reflective vinyl
- Glow-in-the-dark boarder illuminates character for distinct definition in blackout conditions
- Designed for permanent application in severe outdoor environments as well as indoors. Special acrylic adhesive adheres strongly for a secure and permanent application.
- Standard package: 10 identical characters

Catalog Number	Character Height	Marker Size
3000-*	2"	2 1/8" x 1 1/2"
3010-*	3"	3 1/2" x 2 1/2"
3020-*	5"	6" x 3"

To Order: Add letter, number or symbol desired in place of asterisk to complete catalog number. Example: 3000-A, 3000-B, etc. Symbols available: BLNK (blank), DSH (dash), PRD (period) & (ampersand)

Instalign® Prespaced Legends

- Quality self-sticking characters are prespaced into the legends you require
- Legends mounted between an application tape and release liner, enabling you to position your message with precision
- Instalign® lettering can also be applied to blank plaques and blank sign panels, sold separately on page ???
- Legends available in four materials and a variety of colors
- Choose from seven standard symbols
- Legend size: letter sizes range from 1/2" to 12"; symbol sizes range from 1 1/2" to 12"
- Reverse cut letters for application behind clear glass or plastic available only in B-933 white and B-782-7 black and aluminum

Standard Materials and Colors:

B-957 Engineering Quality Reflective Film



Silver Red Green

B-782-7 5-7 Years Outdoor Vinyl Film Quality



Black White Red Yellow Blue Aluminum

B-933 Architectural Matte Finish



Black White

Standard Type Styles:

Helvetica Regular
Helvetica Medium
Gothic (Highway D)
Condensed Gothic (Highway B)



To Order: CTT1051

Specify type style, letter size, material, color and quantity. Indicate uppercase, lowercase or combination where applicable.

Standard Symbols



Customize It

Instalign® Prespaced Legends
Contact your local Brady
Distributor to order

Gothic Quik-Align® Ten Packs

- Made of B-933 vinyl film with permanent adhesive
- Keep your Quik-Align® Kits current by refilling them with Ten Pack replacements
- Packs available in black, yellow, red and white
- Order in 10 packs only, no broken packages
- Standard package: 10 identical characters or arrows per pack; five \$, & and punctuation per pack

Size	Catalog Number			
	Black	Yellow	Red	White
1"	5010-*	5020-*	5030-*	5040-*
2"	5050-*	5060-*	5070-*	5080-*
3"	5100-*	5110-*	5120-*	5130-*
4"	5140-*	5150-*	5160-*	5170-*
6"	5180-*			5210-*

To Order:

Add letter, number or symbol desired to complete each catalog number shown. Use suffix PUN for punctuation, and ARO for arrow. For example 5010-A, 5010-ARO, etc. Order in 10-packs only. No broken packages, ten identical characters or arrows per pack. (\$, & and punctuation are five per pack.)



Durable, self-aligning characters provide a clean, professional appearance.

► Gothic Condensed Ten Packs

- Made of B-933 vinyl film with permanent adhesive
- Packs available only in black
- Order in 10 packs only, no broken packages
- Standard package: 10 identical characters or arrows per pack; five \$, & and punctuation per pack

Size	Color	Catalog Number
1"	Black	6400-*
2"	Black	6450-*
3"	Black	6500-*

Gothic Quik-Align® Kits



The self-spacing, self-aligning diecut characters of the Gothic Quik-Align® Lettering ensure evenly spaced, professional looking signs.

- Characters made of pressure sensitive, matte finish B-933 vinyl, pigmented throughout for durability and fade resistance
- Self-spacing, self-aligning diecut characters interlock for high-quality appearance
- Aggressive adhesive holds for years, both indoors and outdoors, when applied to clean, dry surfaces
- Industrial grade vinyl resists temperature extremes, abrasion and common solvents
- Choose from two Quik-Align® Kit lettering styles: Gothic (available in black, white, yellow and red) or Condensed Gothic (available only in black)
- Each kit contains: 20 each of A, E, I, L, N, O, R, S, T, and numbers 0-9; 10 each of remaining letters; and 5 each of \$, & and punctuation
- Condensed Gothic Style Quik-Align® Lettering in the Condensed Gothic Kit are best for use in limited horizontal space

Gothic Style Quik-Align® Letters/Numbers
ABCDEFGHIJKLMN
OPQRSTUVWXYZ
1234567890

Condensed Gothic Style Quik-Align® Letters/Numbers
(Use for limited horizontal space)
ABCDEFGHIJKLMN
OPQRSTUVWXYZ
1234567890

Gothic Quik-Align® Kits have compartments for easy selection and storage, and offer 560 numbers, letters, punctuation and symbols distributed by frequency of use.

Gothic Style Kit

Size	Catalog Number			
	Black	Yellow	Red	White
1"	52203	52206	52205	52204
2"	52207	52210	52209	52208
3"	52211	52214	52213	52212
4"	52215	52218	52217	52216
6"	52219			52220

Gothic Condensed Style Kit

Size	Color	Catalog Number
1"	Black	52180
2"	Black	52184
3"	Black	52188

3 Series Glow-In-The Dark / Ultra Reflective



3 Series Numbers & Letters reflect light and glow bright combining the highest level of reflectivity with advanced glow-in-the-dark technology.

Identifiable in daytime, low light and blackout conditions, the 3 Series is the ultimate in identification marking.



3 Series Glow-In-The-Dark/Ultra Reflective Numbers & Letters

- The 3 Series combines glow-in-the-dark technology with ultra reflective B309 material - 7x More Reflective Than Other Reflective Material
- Black characters with glow-in-the-dark boarder on a highly reflective silver background
- Unique micro-prism reflectors allow for maximum visibility from a greater distance, wider angle and lower light source than standard reflective vinyl
- Glow-in-the-dark boarder illuminates character for distinct definition in blackout conditions
- Designed for permanent application in severe outdoor environments as well as indoors. Special acrylic adhesive adheres strongly for a secure and permanent application.
- Standard package: 10 identical characters

Catalog Number	Character Height	Marker Size
3000-*	2"	2 1/8" x 1 1/2"
3010-*	3"	3 1/2" x 2 1/2"
3020-*	5"	6" x 3"

To Order: Add letter, number or symbol desired in place of asterisk to complete catalog number. Example: 3000-A, 3000-B, etc. Symbols available: BLNK (blank), DSH (dash), PRD (period) & (ampersand)

Instalign® Prespaced Legends

- Quality self-sticking characters are prespaced into the legends you require
- Legends mounted between an application tape and release liner, enabling you to position your message with precision
- Instalign® lettering can also be applied to blank plaques and blank sign panels, sold separately on page ???
- Legends available in four materials and a variety of colors
- Choose from seven standard symbols
- Legend size: letter sizes range from 1/2" to 12"; symbol sizes range from 1 1/2" to 12"
- Reverse cut letters for application behind clear glass or plastic available only in B-933 white and B-782-7 black and aluminum

Standard Materials and Colors:

B-957 Engineering Quality Reflective Film



B-782-7 5-7 Years Outdoor Vinyl Film Quality

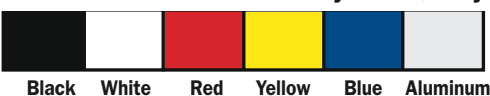

B-933 Architectural Matte Finish



Standard Type Styles:

Helvetica Regular
Helvetica Medium
Gothic (Highway D)
Condensed Gothic (Highway B)



To Order: CTT1051

Specify type style, letter size, material, color and quantity. Indicate uppercase, lowercase or combination where applicable.

Standard Symbols



Customize It

Instalign® Prespaced Legends
Contact your local Brady
Distributor to order

Gothic Quik-Align® Ten Packs

- Made of B-933 vinyl film with permanent adhesive
- Keep your Quik-Align® Kits current by refilling them with Ten Pack replacements
- Packs available in black, yellow, red and white
- Order in 10 packs only, no broken packages
- Standard package: 10 identical characters or arrows per pack; five \$, & and punctuation per pack

Size	Catalog Number			
	Black	Yellow	Red	White
1"	5010-*	5020-*	5030-*	5040-*
2"	5050-*	5060-*	5070-*	5080-*
3"	5100-*	5110-*	5120-*	5130-*
4"	5140-*	5150-*	5160-*	5170-*
6"	5180-*			5210-*

To Order:

Add letter, number or symbol desired to complete each catalog number shown. Use suffix PUN for punctuation, and ARO for arrow. For example 5010-A, 5010-ARO, etc. Order in 10-packs only. No broken packages, ten identical characters or arrows per pack. (\$, & and punctuation are five per pack.)



Durable, self-aligning characters provide a clean, professional appearance.

► Gothic Condensed Ten Packs

- Made of B-933 vinyl film with permanent adhesive
- Packs available only in black
- Order in 10 packs only, no broken packages
- Standard package: 10 identical characters or arrows per pack; five \$, & and punctuation per pack

Size	Color	Catalog Number
1"	Black	6400-*
2"	Black	6450-*
3"	Black	6500-*

Gothic Quik-Align® Kits



The self-spacing, self-aligning diecut characters of the Gothic Quik-Align® Lettering ensure evenly spaced, professional looking signs.

- Characters made of pressure sensitive, matte finish B-933 vinyl, pigmented throughout for durability and fade resistance
- Self-spacing, self-aligning diecut characters interlock for high-quality appearance
- Aggressive adhesive holds for years, both indoors and outdoors, when applied to clean, dry surfaces
- Industrial grade vinyl resists temperature extremes, abrasion and common solvents
- Choose from two Quik-Align® Kit lettering styles: Gothic (available in black, white, yellow and red) or Condensed Gothic (available only in black)
- Each kit contains: 20 each of A, E, I, L, N, O, R, S, T, and numbers 0-9; 10 each of remaining letters; and 5 each of \$, & and punctuation
- Condensed Gothic Style Quik-Align® Lettering in the Condensed Gothic Kit are best for use in limited horizontal space

Gothic Style Quik-Align® Letters/Numbers
ABCDEFGHIJKLMN
OPQRSTUVWXYZ
1234567890

Condensed Gothic Style Quik-Align® Letters/Numbers
(Use for limited horizontal space)
ABCDEFGHIJKLMN
OPQRSTUVWXYZ
1234567890

Gothic Quik-Align® Kits have compartments for easy selection and storage, and offer 560 numbers, letters, punctuation and symbols distributed by frequency of use.

Gothic Style Kit

Size	Catalog Number			
	Black	Yellow	Red	White
1"	52203	52206	52205	52204
2"	52207	52210	52209	52208
3"	52211	52214	52213	52212
4"	52215	52218	52217	52216
6"	52219			52220

Gothic Condensed Style Kit

Size	Color	Catalog Number
1"	Black	52180
2"	Black	52184
3"	Black	52188

Helvetica Quick-Align® Lettering

Helvetica Quik-Align® Ten Packs



Use Helvetica Quik-Align® Lettering in convenient Ten Packs for all of your marking needs.

- Made of B-933 vinyl film with permanent adhesive
- Keep your Quik-Align® Kits current by refilling them with Ten Pack replacements
- Packs available in black and white
- Order in 10 packs only, no broken packages
- Standard package: 10 identical characters per pack; five \$, & and punctuation per pack

To Order:

Add letter, number or symbol desired in place of asterisk to complete each catalog number. Example: 8200-A, 8200-B, etc. Use suffix PUN for punctuation and ARO for arrow. No broken packages.

Size	Catalog Number Black		White	
	Upper Case	Lower Case	Upper Case	Lower Case
1"	8200.*	8235.*	8270.*	8305.*
1½"	8205.*	8240.*	8275.*	8310.*
2"	8210.*	8245.*	8280.*	8315.*
3"	8215.*	8250.*	8285.*	8320.*
4"	8220.*	8255.*	8290.*	8325.*
6"	8230.*	8265.*	8300.*	8335.*

Helvetica Quik-Align® Kits



Quik-Align® characters are accurate reproductions of the Helvetica letter style, which has become the international standard for modern identification.

- Characters made of pressure sensitive, matte finish B-933 vinyl, pigmented throughout for durability and fade resistance
- Characters are located on notched carrier cards that interlock to provide "auto-matic" alignment and interletter spacing
- Aggressive adhesive holds for years, both indoors and outdoors, when applied to clean, dry surfaces
- Industrial grade vinyl resists temperature extremes, abrasion and common solvents
- Available in white and black and six sizes
- Uppercase and lowercase kits available
- Uppercase kit contains 570 vinyl characters: 20 each of A, E, I, L, N, O, R, S, T, and numbers 0-9; 10 arrows and 10 each of remaining letters; 5 each of \$, &, and punctuation
- Lowercase kit contains 350 letters only: 20 each of A, E, I, L, N, O, R, S, T; 10 each of remaining letters

Size	Catalog Number Black		White	
	Upper Case	Lower Case	Upper Case	Lower Case
1"	80000	80010	80020	80030
1½"	80001	80011	80021	80031
2"	80002	80012	80022	80032
3"	80003	80013	80023	80033
4"	80004	80014	80024	80034
6"	80006	80016	80026	80036

Letter sizes refer to capital letters, lowercase are proportional



Unique material characteristics make Helvetica Quik-Align® Lettering durable on a multitude of surfaces and in many environments.

Helvetica Quik-Align® Lettering

The clean, crisp appearance of the Helvetica letter style has become the international standard for modern identification. Quik-Align® characters are accurate reproductions of this letter style. Available in black, white and reflective.

Upper Case

ABCDEFGHIJKLMNOPQRSTUVWXYZ
1234567890

Lower Case

abcdefghijklmnopqrstuvwxyz

Gothic Quik-Align® Ten Packs

- Made of B-933 vinyl film with permanent adhesive
- Keep your Quik-Align® Kits current by refilling them with Ten Pack replacements
- Packs available in black, yellow, red and white
- Order in 10 packs only, no broken packages
- Standard package: 10 identical characters or arrows per pack; five \$, & and punctuation per pack

Size	Catalog Number			
	Black	Yellow	Red	White
1"	5010-*	5020-*	5030-*	5040-*
2"	5050-*	5060-*	5070-*	5080-*
3"	5100-*	5110-*	5120-*	5130-*
4"	5140-*	5150-*	5160-*	5170-*
6"	5180-*			5210-*

To Order:

Add letter, number or symbol desired to complete each catalog number shown. Use suffix PUN for punctuation, and ARO for arrow. For example 5010-A, 5010-ARO, etc. Order in 10-packs only. No broken packages, ten identical characters or arrows per pack. (\$, & and punctuation are five per pack.)



Durable, self-aligning characters provide a clean, professional appearance.

► Gothic Condensed Ten Packs

- Made of B-933 vinyl film with permanent adhesive
- Packs available only in black
- Order in 10 packs only, no broken packages
- Standard package: 10 identical characters or arrows per pack; five \$, & and punctuation per pack

Size	Color	Catalog Number
1"	Black	6400-*
2"	Black	6450-*
3"	Black	6500-*

Gothic Quik-Align® Kits



The self-spacing, self-aligning diecut characters of the Gothic Quik-Align® Lettering ensure evenly spaced, professional looking signs.

- Characters made of pressure sensitive, matte finish B-933 vinyl, pigmented throughout for durability and fade resistance
- Self-spacing, self-aligning diecut characters interlock for high-quality appearance
- Aggressive adhesive holds for years, both indoors and outdoors, when applied to clean, dry surfaces
- Industrial grade vinyl resists temperature extremes, abrasion and common solvents
- Choose from two Quik-Align® Kit lettering styles: Gothic (available in black, white, yellow and red) or Condensed Gothic (available only in black)
- Each kit contains: 20 each of A, E, I, L, N, O, R, S, T, and numbers 0-9; 10 each of remaining letters; and 5 each of \$, & and punctuation
- Condensed Gothic Style Quik-Align® Lettering in the Condensed Gothic Kit are best for use in limited horizontal space

Gothic Style Quik-Align® Letters/Numbers
ABCDEFGHIJKLMN
OPQRSTUVWXYZ
1234567890

Condensed Gothic Style Quik-Align® Letters/Numbers
(Use for limited horizontal space)
ABCDEFGHIJKLMN
OPQRSTUVWXYZ
1234567890

Gothic Quik-Align® Kits have compartments for easy selection and storage, and offer 560 numbers, letters, punctuation and symbols distributed by frequency of use.

Gothic Style Kit

Size	Catalog Number			
	Black	Yellow	Red	White
1"	52203	52206	52205	52204
2"	52207	52210	52209	52208
3"	52211	52214	52213	52212
4"	52215	52218	52217	52216
6"	52219			52220

Gothic Condensed Style Kit

Size	Color	Catalog Number
1"	Black	52180
2"	Black	52184
3"	Black	52188

Helvetica Quick-Align® Lettering

Helvetica Quik-Align® Ten Packs



Use Helvetica Quik-Align® Lettering in convenient Ten Packs for all of your marking needs.

- Made of B-933 vinyl film with permanent adhesive
- Keep your Quik-Align® Kits current by refilling them with Ten Pack replacements
- Packs available in black and white
- Order in 10 packs only, no broken packages
- Standard package: 10 identical characters per pack; five \$, & and punctuation per pack

To Order:

Add letter, number or symbol desired in place of asterisk to complete each catalog number. Example: 8200-A, 8200-B, etc. Use suffix PUN for punctuation and ARO for arrow. No broken packages.

Size	Catalog Number Black		White	
	Upper Case	Lower Case	Upper Case	Lower Case
1"	8200.*	8235.*	8270.*	8305.*
1½"	8205.*	8240.*	8275.*	8310.*
2"	8210.*	8245.*	8280.*	8315.*
3"	8215.*	8250.*	8285.*	8320.*
4"	8220.*	8255.*	8290.*	8325.*
6"	8230.*	8265.*	8300.*	8335.*

Helvetica Quik-Align® Kits



Quik-Align® characters are accurate reproductions of the Helvetica letter style, which has become the international standard for modern identification.

- Characters made of pressure sensitive, matte finish B-933 vinyl, pigmented throughout for durability and fade resistance
- Characters are located on notched carrier cards that interlock to provide "auto-matic" alignment and interletter spacing
- Aggressive adhesive holds for years, both indoors and outdoors, when applied to clean, dry surfaces
- Industrial grade vinyl resists temperature extremes, abrasion and common solvents
- Available in white and black and six sizes
- Uppercase and lowercase kits available
- Uppercase kit contains 570 vinyl characters: 20 each of A, E, I, L, N, O, R, S, T, and numbers 0-9; 10 arrows and 10 each of remaining letters; 5 each of \$, &, and punctuation
- Lowercase kit contains 350 letters only: 20 each of A, E, I, L, N, O, R, S, T; 10 each of remaining letters

Size	Catalog Number Black		White	
	Upper Case	Lower Case	Upper Case	Lower Case
1"	80000	80010	80020	80030
1½"	80001	80011	80021	80031
2"	80002	80012	80022	80032
3"	80003	80013	80023	80033
4"	80004	80014	80024	80034
6"	80006	80016	80026	80036

Letter sizes refer to capital letters, lowercase are proportional



Unique material characteristics make Helvetica Quik-Align® Lettering durable on a multitude of surfaces and in many environments.

Helvetica Quik-Align® Lettering

The clean, crisp appearance of the Helvetica letter style has become the international standard for modern identification. Quik-Align® characters are accurate reproductions of this letter style. Available in black, white and reflective.

Upper Case

ABCDEFGHIJKLMNOPQRSTUVWXYZ
1234567890

Lower Case

abcdefghijklmnopqrstuvwxyz

Reflective Quik-Lite® Ten Packs

- Made of B-957 reflective material with permanent, aggressive adhesive
- Keep your Quik-Lite® Kits current by refilling them with Ten Pack replacements
- Order in 10 packs only, no broken packages
- Standard package: 10 identical characters or arrows per pack; five \$, & and punctuation per pack

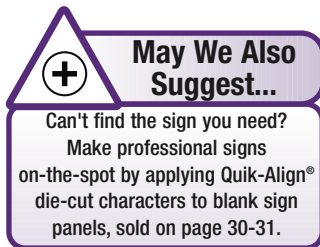

To Order:

Add letter, number or symbol desired in place of asterisk to complete each catalog number. Example: 9720-A, 9720-B, etc. Use PUN for punctuation and ARO for arrow.

Character Size	10 Packs Reflective	
	Upper Case	Lower Case
1"	9720.*	9703.*
1½"	9730.*	9704.*
2"	9740.*	9705.*
3"	9750.*	9706.*
4"	9760.*	9707.*
6"	9770.*	9708.*

Letter sizes refer to capital letters, lowercase are proportional

Reflective Quik-Lite® Kits

- Made of B-957 reflective material with permanent, aggressive adhesive
- Quik-Lite® Letters reflect light 200 times brighter than a white surface
- Letters grip firmly to most clean, dry surfaces, indoors and outdoors - weather resistant and long lasting
- Available in white only
- Uppercase and lowercase kits available
- Uppercase kit contains 570 vinyl characters: 20 each of A, E, I, L, N, O, R, S, T, and numbers 0-9; 10 arrows and 10 each of remaining letters; 5 each of \$, &, and punctuation
- Lowercase kit contains 350 letters only: 20 each of A, E, I, L, N, O, R, S, T; 10 each of remaining letters

Character Size	Kits Reflective	
	Upper Case	Lower Case
1"	97546	97547
1½"	97548	97549
2"	97550	97551
3"	97552	97553
4"	97554	97555
6"	97556	97557

Letter sizes refer to capital letters, lowercase are proportional



Top line of sign is lettered with Quik-Lite™ diecuts, showing contrast with non-reflective lettering on rest of sign in night-time viewing situation.

Marking Panels / Numbers & Letters

Aluminum Embossed Numbers & Letters



Aluminum Embossed Numbers & Letters are ideal for marking utility poles.

- Roman style numbers and letters
- Letter and number size: 3"
- Contain pre-punched holes for easy installation
- 1" nails included
- Standard package: 10 identical characters

To Order:

Substitute the number or letter you need for the asterisk following the catalog number.

Catalog Number	Character Height	Style
1600-*	3"	Roman

Fiber-Shield® Numbers & Letters



Applications for Fiber-Shield® Numbers & Letters include identification of picking aisles in warehouses, dock doors, parking spaces, and utility pole numbering.

- Made of B-120 fiberglass
- Black on white numbers and letters offer bold, easy to read graphics for indoor or outdoor use - guaranteed 15 years outdoors!
- Two letter heights available and three sizes
- All sizes are supplied with square corners and four 7/8" corner holes

To Order:

Add letter or number desired to complete catalog number. 1-25, A-Z are available from stock in 7710 & 7720 Series. 01-25 are available in 7730 Series.

Character Height	Size Height x Width	Catalog Number
8"	10" x 7"	7710-*
12"	14" x 10"	7720-*
8"	10" x 14"	7730-*

Bin Marking Panels



Bin Marking Panels made of semi-rigid polystyrene will flex if accidentally hit, protecting people, equipment and packages.

- Made of B-793 material, .060" thick polystyrene panels with matte white finish
- Panels accept Quik-Align® Numbers & Letters (sold on pages 184-187) or custom Bintab™ Labels (see below) for on-the-spot marking
- Panels can be mounted with screws to extend into aisles or can be mounted using magnetic strips, adhesive tape strips or Bradyfoam™ Mounting Tape
- Available in five sizes
- Standard package: 10 panels

Size	Catalog Number
4" x 5 3/4"	58307
4" x 7 1/2"	58308
4" x 9 1/4"	58309
4" x 11"	58310
8" x 12"	58312



Custom Brady Bintab™ System

- Custom labeling method designed to meet your specific storage identification needs.
- Ideal for warehouse or work-in-process operations.
- Combine part number, descriptions, locations, bar codes and different type sizes on the same label.



1

Materials (Check appropriate material)

- ☐ B-826 Permanent w/o overlamine
- ☐ B-704 Permanent label w/overlamine
- ☐ B-822 Repositionable label w/o overlamine
- ☐ B-824 Repositionable label w/overlamine

2

Size In inches. (Check appropriate size)

- ☐ .9 x 1.5 ☐ 1.4 x 1.5 ☐ 1.9 x 4.0 ☐ 2.5 x 4.0 ☐ 2.9 x 4.0
- ☐ .9 x 3.0 ☐ 1.4 x 3.0 ☐ 1.9 x 6.0 ☐ 2.5 x 6.0 ☐ 2.9 x 6.0
- ☐ .9 x 4.0 ☐ 1.4 x 4.0 ☐ 1.9 x 12.0 ☐ 2.5 x 8.25 ☐ 2.9 x 12.0
- ☐ .9 x 6.0 ☐ 1.4 x 6.0
- ☐ .9 x 8.25 ☐ 1.4 x 8.25

3

Color (Check appropriate selection)

- ☐ Black on White ☐ Black on Yellow

4

Options (Check appropriate selection)

- Bar Codes: ☐ .3 of 9 ☐ .UPC
- ☐ .interleaved 2 of 5 ☐ .128

5

Legend (Specify legend)

6

CONTACT your local Brady distributor to place your order.

Selecting Your Printer



Page 191



Page 192



Page 196



Page 200

Features

Keyboard	ABC	ABC	ABC / QWERTY	ABC
Print Technology	THERMAL TRANSFER 180dpi	THERMAL TRANSFER 203dpi	THERMAL TRANSFER 300dpi	THERMAL TRANSFER 203dpi
Weight	1.2 lbs.	2.75 lbs.	2.4 lbs.	2.75 lbs.
Label Width	.750"	2.00"	1.50"	2.00"
Text sizes	5 (7to 28 font)	19 (4 to 72 font)	11 (7 to 128 point)	19 (4 to 72 point)
Roll length (max)	21'	50' / 500' bulk	30'	50' / 500' bulk
Consumables	Continuous 15 stock parts	Continuous / Die cut 65 stock parts	Continues / Die cut 89 stock part	Continuous / Die cut Over 350 stock + Custom
PC Connectivity	No	Firmware Peripheral printing	Firmware	Firmware Peripheral printing
Memory	Last label	10,000 Characters 20+ individual labels	10 labels	21,000 Characters 10 label lists 10+ labels per list
Power Supply	6 AA batteries AC power (optional)	Rechargeable battery AC power (optional)	6 AA batteries AC power (optional)	Rechargeable battery AC power (optional)
Applications	Wire & Cable Marking Bins & Storage General Marking	Panel & Switch ID Junction Boxes Instrumentation ID Gauges Pipe Markers Bins & Storage Asset ID Warning Labels	Wire & Cable (wrap around, self-laminating permasleeve) Data Communications Bins & Storage General & Industrial Marking	Wire & Cable (wrap around, self-laminating permasleeve) Data Communications Bins & Storage General & Industrial Marking Circuit board & component ID Laboratory ID



May We Also Suggest...

Bench Top Printers

- PowerMark™ Sign and Label Maker lets you create industrial strength signs and labels, 4 to 10 inches wide, in up to four colors. See page 216 for more information.
- GlobalMark® Industrial Label Maker will create your own custom signs, labels, pipemarkers, tags and more on demand with this easy to use, industrial label printer. See page 208 for more information.
- MiniMark™ Industrial Label Printer offers an affordable sign and labelmaking system that is compact, fast, and incredibly versatile. See page 214 for more information.



Software

- MarkWare™ Tape and Label Software on your PC quickly designs professional-looking signs, labels and tags. See page 228 for more information.
- ChemLabel™ Hazardous Material Labeling Software will make it easy to create and print labels for hazardous substance. See page 232 for more information.
- Surf on Signs™ Signs and Label Database allows you to search from thousands of signs, labels, pipe markers or tags and print what you need directly to your Brady printer. See page 234 for more information.

